

Pablo®

BELMONT

ASSEMBLY & INSTALLATION INSTRUCTIONS

INFO@PABLODESIGNS.COM
888 MARIN STREET
SAN FRANCISCO, CA
94124

PABLODESIGNS.COM
PABLODESIGNS.EU



BELMONT

1. ATTACH MOUNTING PLATE TO JUNCTION BOX (US)
ATTACH MOUNTING PALTE TO CEILING (EU)
2. SLIDE CORDS THROUGH LENS COVER AND SNAP IN PLACE. MAKE SURE TEXTURED SIDE FACES OUT.
3. SLIDE CORD THROUGH WOOD CANOPY COVER AND REST COVER ON LAMP.
4. LOOSEN SET SCREWS ON STRAIN RELIEFS.
5. SLIDE CORD THROUGH STRAIN RELIEFS.
CUT CORD TO LENGTH LEAVING AN EXTRA 6-8 IN.
(16-20CM)

1

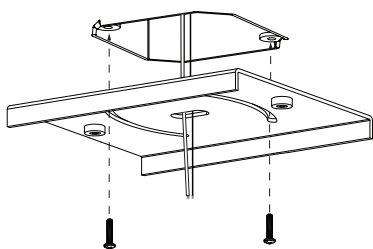

US

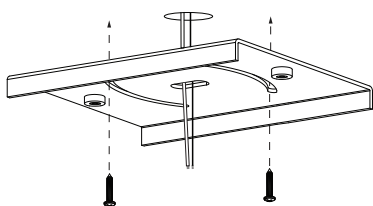

EU

2

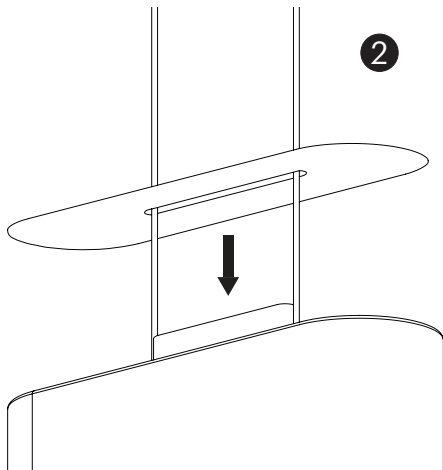

3

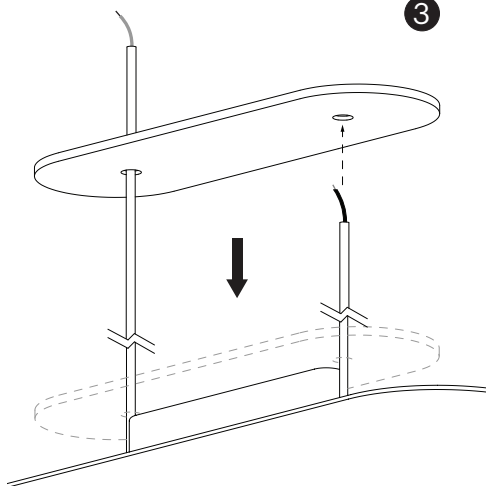

4

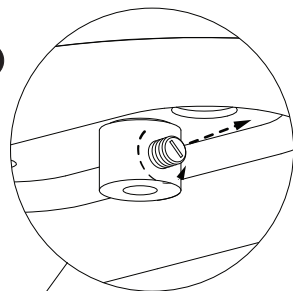

5

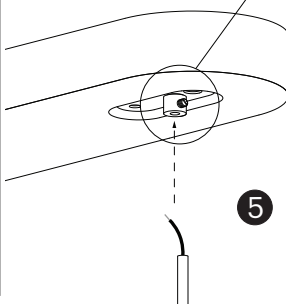

BELMONT

6. WIRE POWER CORD TO TRANSFORMER:

(US: BLUE TO BLACK AND RED TO RED)

(EU: RED TO RED AND BLACK TO BLACK)

7. WIRE TRANSFORMER TO JUNCTION BOX:

(US: BLACK TO BLACK AND WHITE TO WHITE)

(EU: BLUE TO BLACK AND BROWN TO RED)

8. SCREW CANOPY TO MOUNTING PLATE.

9. LEVEL THE LIGHT BY ADJUSTING THE CORDS.

10. TIGHTEN SET SCREW.

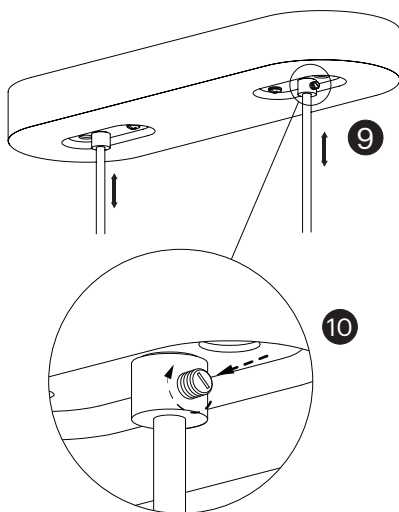
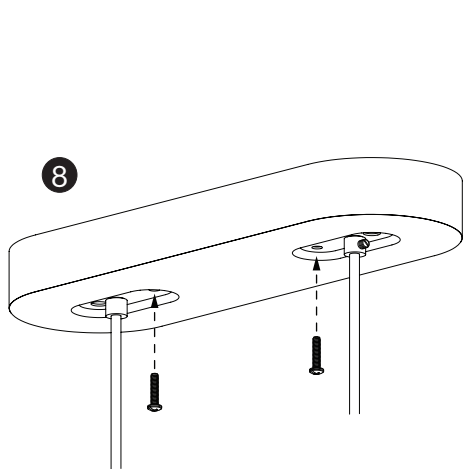
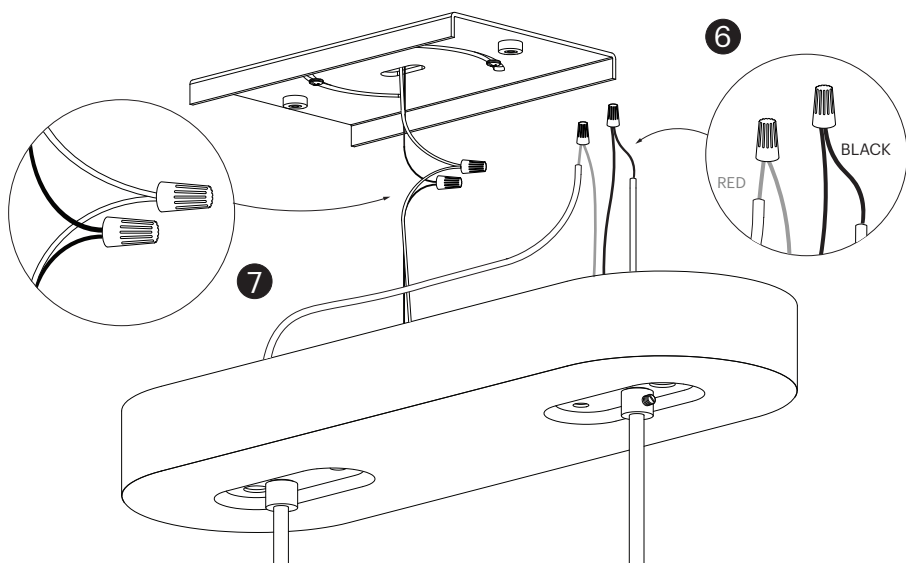

BELMONT

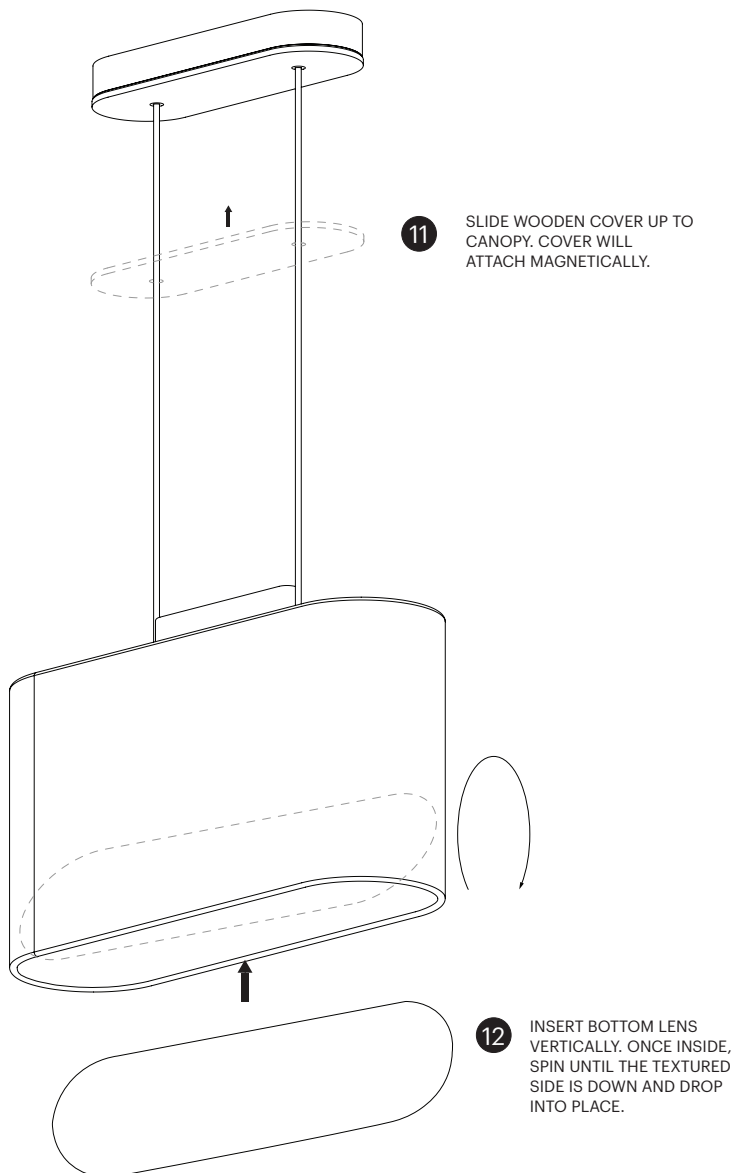

CARE INSTRUCTIONS

LIGHT – WIPE WITH A CLEAN, DRY CLOTH.

SHADE – TO REMOVE DUST AND SMALL DEBRIS: CLEAN WITH A SOFT HAIR BRUSH OR USE A VACUUM.
TO REMOVE OTHER SUBSTANCES: USE A DAMP CLOTH AND IF NEEDED A MILD DETERGENT.
AVOID AMMONIA-BASED CLEANERS.